

Key

- ① ——— Decothane Top Coat as per Sika Liquid Plastics Project Specification
- ② ——— Decothane Base Coat with embedded Reemat Premium GFM
- ③ Existing substrate prepared and primed in strict accordance with Sika Liquid Plastics Project Specification
- ④ Mechanically fixed tanalised timber fillet
- ⑤ - - - Existing sarking dressed over the termination position of the fully reinforced Decothane Waterproofing System
- ⑥ Existing roof tiles/slates and existing sarking felt must be checked by a competent person to guarantee the roof waterproofing integrity as forced-entry rainwater ingress must be eliminated from the pitched roof

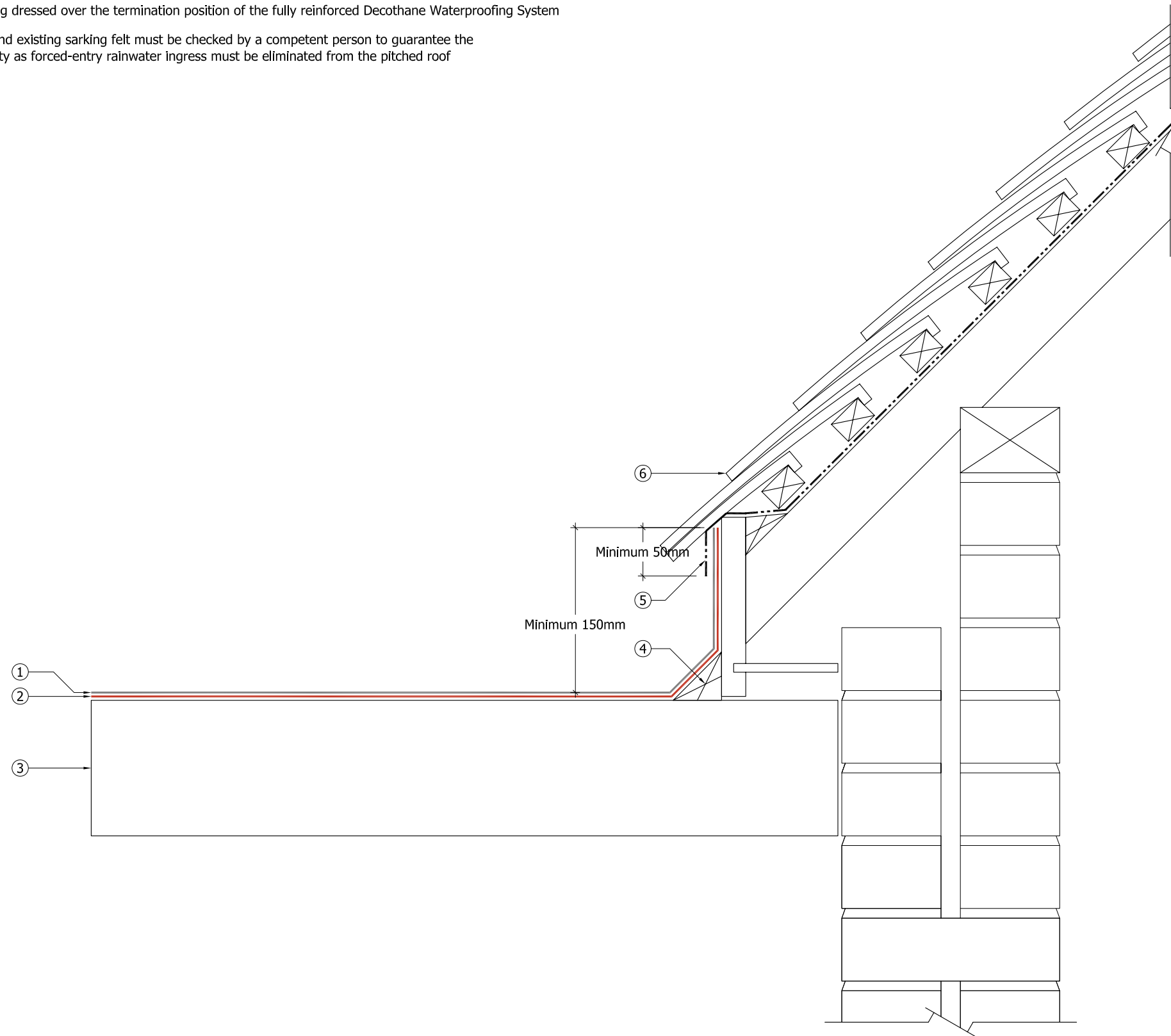

Sika Liquid Plastics
 Sika House
 Miller Street
 Preston
 Lancashire PR1 1EA
 Telephone: 01772 259781
 Email: technical.customer.services@uk.sika.com
 Web: www.liquidplastics.co.uk

This drawing is solely intended to illustrate the correct application of Sika Liquid Plastics products and systems, it must be read in conjunction with the appropriate specification and current issue of relevant Technical Data Sheets. All elements bearing reference to structural and/or thermal design are shown indicatively and should not be used in whole or in part for any aspect of project design without consulting the relevant authorities.

For refurbishment projects, all aspects of the existing roof are deemed to be fully compliant with BS 6229:2003 [Code of Practice for Flat Roofs with Continuously Supported Coverings] or improved upon for instances where these standards are not met.

Site-specific details not covered by our range of Standard Details can be obtained by providing relevant information to the email address shown.

Project No:

DWG No: Revision

Project:

Drawing Title:
 Waterproofing Termination Detail
 Flat roof abutment to an existing
 slate/tilled eaves detail with fascia

Scale: NTS @ A3 Drawn:

Date:

